

Stabilized Compact Red CrystaLaser®

High reliability High stability Single longitudinal mode Circular beam

SPECIFICATIONS

| Wavelength | Option ± 1 nm available | Low noise version, Model No. | | | | SLM version, Model No. | | | |
|---------------------------------------|-----------------------------|--|--------|---|--------|---|--------|-------------|--------|
| 635 ± 1 nm | | DL635-025 | 25 mW | DL635-035 | 35 mW | DL635-025-S | 25 mW | DL635-035-S | 35 mW |
| 638 ± 2 nm | | DL638-025 | 25 mW | DL638-070 | 70 mW | DL638-025-S | 25 mW | DL638-070-S | 70 mW |
| | | DL638-035 | 35 mW | DL638-100 | 100 mW | DL638-035-S | 35 mW | DL638-100-S | 100 mW |
| | | DL638-050 | 50 mW | | | DL638-050-S | 50 mW | | |
| 642 ± 4 nm | 647 ± 1 nm option available | DL640-025 | 25 mW | DL640-070 | 70 mW | DL640-025-S | 25 mW | DL640-070-S | 70 mW |
| | | DL640-050 | 50 mW | DL640-100 | 100 mW | DL640-040-S | 40 mW | DL640-100-S | 100 mW |
| 660 ± 5 nm | 655 ± 1 nm option available | DL660-025 | 25 mW | DL660-100 | 100 mW | DL660-025-S | 25 mW | | |
| | | DL660-035 | 50 mW | | | DL660-050-S | 50 mW | | |
| 690 ± 5 nm | | DL660-030 | 30 mW | DL660-050 | 50 mW | DL690-030-S | 30 mW | DL690-050-S | 50 mW |
| 785 ± 5 nm | 780 nm available | DL785-100 | 100 mW | DL785-120 | 120 mW | DL785-100-S | 100 mW | DL785-120-S | 120 mW |
| Longitudinal mode | | Multiple | | | | Single | | | |
| Spectrum linewidth | | 1 nm, typical | | | | < 0.00001 nm or < 10 MHz | | | |
| Coherence length | | < 0.3 mm | | | | > 10 meters or > 100 meters option | | | |
| Output noise (rms, 10Hz-50MHz) | | < 0.5 % | | | | < 0.5 % | | | |
| Output stability over 24 hours (rms) | | < 1 %; Option: ultra-stable version < 0.25% | | | | 2 % Option: ultra-stable version < 0.5% | | | |
| Modulation options | | TTL 200Hz, 50kHz, 20MHz, 100 MHz, 200MHz; Analog control, Analog modulation | | | | TTL on/off option | | | |
| Transverse mode | | Circular beam, close to TEM ₀₀ , M ² = 1.1 - 1.3 | | | | | | | |
| Beam diameter (1/e ²) | | 1.1 mm | | Option: 0.7X - 3X laser beam expanders are available to change beam size and divergence. e.g. 0.8 mm beam with 1.3 mrad divergence; or 2.5 mm beam with 0.4 mrad divergence | | | | | |
| Beam divergence | | 1 mrad | | | | | | | |
| Beam pointing stability | | < 0.005 mrad/°C | | | | | | | |
| Polarization ratio | | 100:1; Vertical linear polarization | | | | | | | |
| Operation temperature | | 5 °C to 40 °C, internal TEC temperature-stabilized, no additional heat sink required | | | | | | | |
| Warm-up time | | < 30 seconds | | | | | | | |
| Operation voltage | | 90-250 VAC or 12VDC OEM version 11-16VDC | | | | | | | |
| Dimensions and weight of laser head | | 3 x 3.6 x 13.5 cm ³ (1.2 x 1.4 x 5.3 in ³), 0.3 kg (0.6 lb) | | | | | | | |
| Dimensions and weight of power supply | | Standard AC: 5 x 14 x 15 cm ³ (2 x 5.5 x 6 in ³), 0.5 kg (1 lb); CL-2005 power display AC: 5 x 16 x 15 cm ³ 12 VDC OEM version: Integrated inside the laser head. | | | | | | | |

Applications: Holographics, Flow cytometry, Fluorescence, Confocal microscopy, Raman Spectroscopy

Fiber coupling option: Single mode and multi-mode fiber delivery.

CL-2005 power supply option: Power adjustable and power digital display.

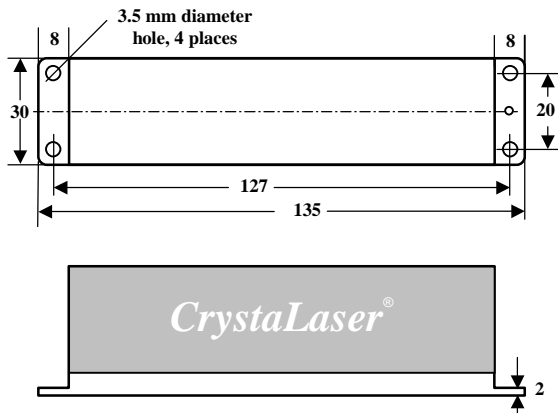

All dimensions in mm

Front View

Laser beam is output from this aperture

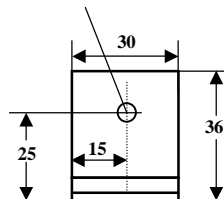

Made in the USA